

Glow Instructions

FORM-A-TREAD®

GLOW™

Cartridge Dispensing Instructions



Unscrew cap and remove plug



Dispense small amount until both sides dispense evenly



Screw on Mix Nozzle.
Dispense and discard first 2 inches of material.

Installation Instructions

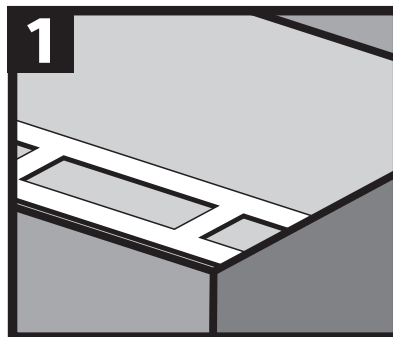

Apply EZ Form™ to desired tread location. Remove connecting tabs

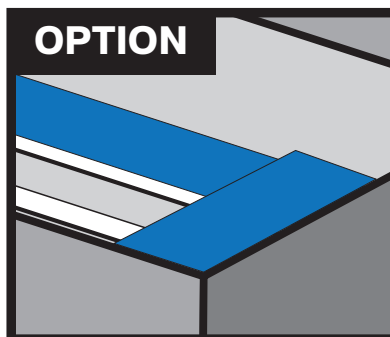

OPTION
Apply painter's tape
(to form a clean edge and for easier clean up)

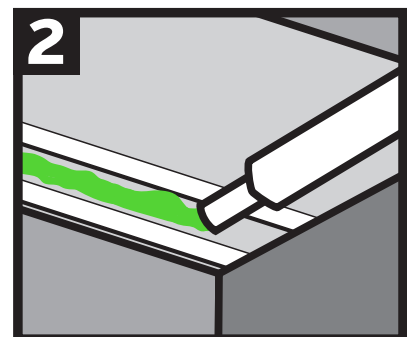

Follow cartridge dispensing instructions and apply Form-A-Tread GLOW

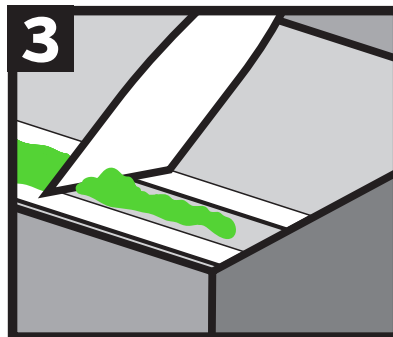

Spread Form-A-Tread GLOW to the level of the EZ Form

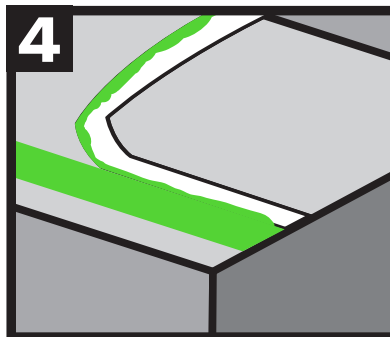

Remove EZ Form within 30 minutes